

Worm Drive Mini Clip

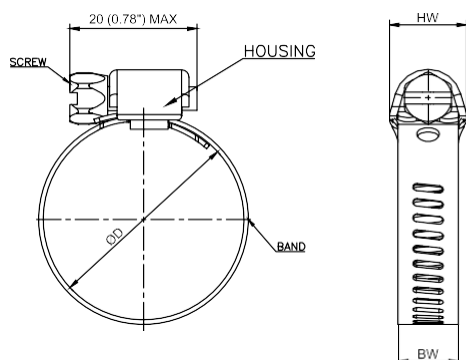

Ref. standard: SAE J1508 Type "M"

- Suitable small hose diameter applications.
- Generally used for Emission control, fuel line, vacuum hoses.

Jolly Sizes as per SAE Standard

Jolly Size Ordering Code	SAE Sizes	Min Dia (in)	Max Dia (in)	Min Dia (mm)	Max Dia (mm)
02	-	1/4	1/2	6	12
04	04	5/16	5/8	6	16
06	06	5/16	7/8	8	22
08	08	7/16	1	11	25
10	10	1/2	1-1/16	13	27
12	12	9/16	1-1/4	14	32

Additional sizes are available as per enquiry.

Short Description

Jolly Mini Clip is designed for Low Pressure & Light duty applications. It is suitable for small hose diameter applications like Fuel & Air lines & Vacuum Hoses. Jolly Mini Clip is designed as per SAE standard & can be used upto Max. application torque of 1.2Nm for screw SS 300 & for pcs screw 1.61Nm

Example for Ordering Code

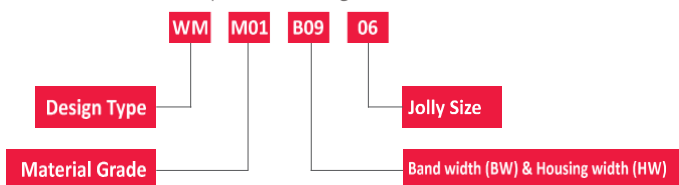

Design Type Ordering Code : WM

Ordering Code	Material Grade Option
M01	All parts : SS 304
M06	All parts : SS316
M07	Band & Housing : SS 201 / 202 Screw : Plated Carbon Steel

Ordering Code	Band (BW) & Housing (HW) Width Options
B09	Band : 8 mm (0.31") Housing : 10 mm (0.4")

Area of Application

Agricultural • Light Duty Automotive • Industrial • Domestic • Hardware

Products are manufactured as per SAE / J 1508 and BS 5315 standard

We reserve the right to make technical & dimensional modifications within Standard specification .
UPC code made available on request.
Packing Specification available.